

## PRODUCT INTRODUCTION

YKK/YXKK series motors stand out for high efficiency, high energy savings, low vibration, low weight, compact structure, reliable operation and convenient maintenance. The motors comply with the national standard GB755 "rotating electrical machines-rating and performance" and the relevant international standards, and suitable to drive compressors, fans, water pumps, industrial freezers, conveyor belts, crushers and other general machinery. Please specify the requirements in the order when motors are mounted on high moment of inertia equipment like blower, coal pulverizer, rolling mill, winch and belt conveyor.

The motor frame is welded by steel plate, and offer excellent rigidity and vibration resistance performance. They are manufactured with F insulation structure and VPI vacuum pressure impregnation process. The non-stop filling and discharging bearing system ensures a convenient maintenance. Special requirements on voltage, power, frequency and mounting dimension can be customized. YKS water cooling motors have the same power range, performance and dimension as Y series.

## SPECIFICATION

Frame size: 355-630MM (6KV)、 400-630MM (10KV)Rated power: 0.718kW-315kW

Voltage and frequency: 220KW-1120KW (6KV)、 220KW-1120KW (10KV)

Degrees of protections: IP55

Degrees of insulation/Temperature rise: F

Installation Method: IMB3

Number of poles:2/4/6/8/10

Ambient temperature: -15°C~+40°C

Relative humidity should be less than 90%

Altitude should be lower than 1000 m above sea level

Cooling Method: IC611、 IC616

## YKK Series High Voltage Motor (6kv)

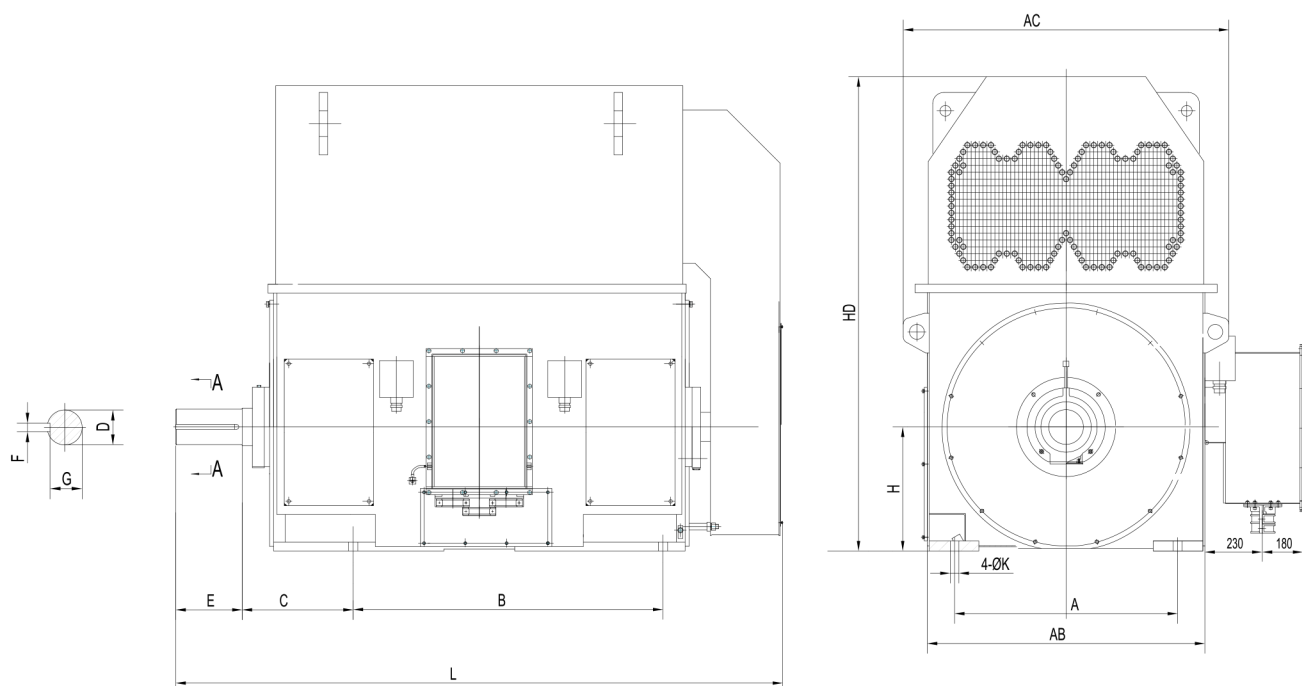

Frame	Pole	A	B	C	D	E	F	G	H	K	AB	AC	HD	L
355	2	630	900	315	80	170	22	71	355	28	800	994	1480	2150
355	4	630	900	315	100	210	28	90	355	28	800	994	1480	2150
400	2	710	1000	375	90	170	25	81	400	35	900	1094	1490	2290
400	4-8	710	1000	335	110	210	28	100	400	35	900	1094	1490	2290
450	2	800	1120	400	100	210	28	90	450	35	980	1174	1750	2430
450	4	800	1120	355	120	210	32	109	450	35	980	1174	1550	2385
450	6-12	800	1120	355	130	250	32	119	450	35	980	1174	1550	2425
500	2	900	1250	560	110	210	28	100	500	42	1120	1314	1980	2630
500	4	900	1250	475	130	250	32	119	500	42	1120	1314	1780	2600
500	6-12	900	1250	475	140	250	36	128	500	42	1120	1314	1780	2600
560	2	1000	1400	560	130	250	32	119	560	42	1220	1410	2100	2780
560	4	1000	1400	500	150	250	36	138	560	42	1220	1410	1900	2780
560	6-12	1000	1400	500	160	300	40	147	560	42	1220	1410	1900	2780
630	2	1120	1600	560	140	250	36	128	630	48	1360	1620	2250	3040
630	4	1120	1600	530	170	300	40	157	630	48	1360	1620	2250	2975
630	6-12	1120	1600	530	180	300	45	165	630	48	1360	1620	2250	2975
710	2	1400	1800	530	160	300	40	147	710	56	1600	1860	2250	3490
710	4-16	1400	1800	530	200	350	45	185	710	56	1600	1860	2300	3550



Type	kW	r/min	A	%	cos $\phi$	$\frac{T_{st}}{T_n}$	$\frac{I_{st}}{I_n}$	$\frac{T_{max}}{T_n}$	kg
YKK3551-2	220	2980	26.9	92.5	0.85	0.6	7.0	1.8	2470
YKK3552-2	250	2980	30.6	92.6	0.85	0.6	7.0	1.8	2700
YKK3553-2	280	2980	34.2	92.8	0.85	0.6	7.0	1.8	2730
YKK3554-2	315	2980	38.3	93.1	0.85	0.6	7.0	1.8	2750
YKK4002-2	355	2980	42.5	93.4	0.86	0.6	7.0	1.8	3540
YKK4003-2	400	2980	47.8	93.7	0.86	0.6	7.0	1.8	3570
YKK4004-2	450	2980	53.6	94.0	0.86	0.6	7.0	1.8	3590
YKK4005-2	500	2980	59.4	94.2	0.86	0.6	7.0	1.8	3620
YKK4502-2	560	2980	66.4	94.4	0.86	0.6	7.0	1.8	4325
YKK4503-2	630	2980	73.7	94.6	0.87	0.6	7.0	1.8	4300
YKK4504-2	710	2980	82.9	94.7	0.87	0.6	7.0	1.8	4365
YKK4505-2	800	2980	93.3	94.8	0.87	0.6	7.0	1.8	4430
YKK5001-2	900	2980	105	95.0	0.87	0.6	7.0	1.8	5310
YKK5002-2	1000	2980	116	95.1	0.87	0.6	7.0	1.8	5510
YKK5003-2	1120	2980	130	95.2	0.87	0.6	7.0	1.8	5710
YKK5004-2	1250	2980	145	95.3	0.87	0.6	7.0	1.8	5910
YKK5601-2	1400	2980	161	95.4	0.88	0.6	7.0	1.8	6700
YKK5602-2	1600	2980	183	95.5	0.88	0.6	7.0	1.8	7100
YKK5603-2	1800	2980	206	95.6	0.88	0.6	7.0	1.8	7500
YKK6301-2	2000	2980	229	95.7	0.88	0.6	7.0	1.8	9700
YKK6302-2	2240	2980	256	95.8	0.88	0.6	7.0	1.8	9800
YKK6303-2	2500	2980	285	95.9	0.88	0.6	7.0	1.8	10020
YKK7101-2	2800	2980	315	96.0	0.89	0.6	7.0	1.8	14370
YKK7102-2	3150	2980	354	96.1	0.89	0.6	7.0	1.8	14690
YKK7103-2	3550	2980	399	96.2	0.89	0.6	7.0	1.8	15230
YKK7104-2	4000	2980	449	96.3	0.89	0.6	7.0	1.8	15450
YKK3551-4	185	1490	22.6	92.8	0.85	0.7	6.5	1.8	2280
YKK3552-4	200	1490	24.4	92.9	0.85	0.7	6.5	1.8	2325
YKK3553-4	220	1490	26.8	93.0	0.85	0.7	6.5	1.8	2390
YKK3554-4	250	1490	30.4	93.1	0.85	0.7	6.5	1.8	2450
YKK4002-4	280	1490	33.6	93.2	0.86	0.7	6.5	1.8	3780
YKK4003-4	315	1490	37.8	93.3	0.86	0.7	6.5	1.8	3845
YKK4004-4	355	1490	42.5	93.5	0.86	0.7	6.5	1.8	3925
YKK4005-4	400	1490	47.8	93.7	0.86	0.7	6.5	1.8	4050
YKK4006-4	450	1490	53.6	93.9	0.86	0.7	6.5	1.8	4160
YKK4502-4	500	1490	59.5	94.0	0.86	0.7	6.5	1.8	4370
YKK4503-4	560	1490	66.5	94.2	0.86	0.7	6.5	1.8	4460
YKK4504-4	630	1490	74.7	94.4	0.86	0.7	6.5	1.8	4530
YKK4505-4	710	1490	84.0	94.6	0.86	0.7	6.5	1.8	4680
YKK5001-4	800	1490	93.3	94.8	0.87	0.7	6.5	1.8	5500
YKK5002-4	900	1490	105	94.9	0.87	0.7	6.5	1.8	5830
YKK5003-4	1000	1490	116	95.0	0.87	0.7	6.5	1.8	6025
YKK5004-4	1120	1490	130	95.1	0.87	0.7	6.5	1.8	6235
YKK5601-4	1250	1490	144	95.2	0.88	0.6	6.5	1.8	7150
YKK5602-4	1400	1490	161	95.3	0.88	0.6	6.5	1.8	8100
YKK5603-4	1600	1490	183	95.4	0.88	0.6	6.5	1.8	9050
YKK6301-4	1800	1490	206	95.5	0.88	0.6	6.5	1.8	11250

Type	kW	r/min	A	%	cos $\phi$	$\frac{T_{st}}{T_n}$	$\frac{I_{st}}{I_n}$	$\frac{T_{max}}{T_n}$	kg
YKK6302-4	2000	1490	228.8	95.6	0.88	0.6	6.5	1.8	12220
YKK6303-4	2240	1490	255.9	95.7	0.88	0.6	6.5	1.8	13100
YKK7101-4	2500	1490	291.1	96.1	0.86	0.5	7.0	1.8	14870
YKK7102-4	2800	1490	325.7	96.2	0.86	0.5	7.0	1.8	15300
YKK7103-4	3150	1490	361.8	96.3	0.87	0.5	7.0	1.8	15500
YKK7104-4	3550	1490	407.7	96.3	0.87	0.5	7.0	1.8	15970
YKK4001-6	185	990	23.5	92.4	0.82	0.7	6.0	1.8	2470
YKK4002-6	200	990	25.3	92.6	0.82	0.7	6.0	1.8	2520
YKK4003-6	220	990	27.8	92.8	0.82	0.7	6.0	1.8	3860
YKK4004-6	250	990	31.5	93.0	0.82	0.7	6.0	1.8	3900
YKK4005-6	280	990	35.2	93.3	0.82	0.7	6.0	1.8	3950
YKK4006-6	315	990	39.5	93.5	0.82	0.7	6.0	1.8	4060
YKK4502-6	355	990	43.9	93.7	0.83	0.7	6.0	1.8	4300
YKK4503-6	400	990	49.4	93.8	0.83	0.7	6.0	1.8	4350
YKK4504-6	450	990	55.4	94.1	0.83	0.7	6.0	1.8	4470
YKK4505-6	500	990	61.5	94.3	0.83	0.7	6.0	1.8	4600
YKK5001-6	560	990	68.0	94.4	0.84	0.7	6.0	1.8	5515
YKK5002-6	630	990	76.4	94.5	0.84	0.7	6.0	1.8	5590
YKK5003-6	710	990	85.8	94.8	0.84	0.7	6.0	1.8	5810
YKK5004-6	800	990	96.6	94.9	0.84	0.7	6.0	1.8	6010
YKK5601-6	900	990	107	95.0	0.85	0.7	6.5	1.8	7650
YKK5602-6	1000	990	119	95.1	0.85	0.7	6.5	1.8	7780
YKK5603-6	1120	990	133	95.2	0.85	0.7	6.5	1.8	7900
YKK6301-6	1250	990	147	95.3	0.86	0.7	6.5	1.8	8730
YKK6302-6	1400	990	164	95.4	0.86	0.7	6.5	1.8	11250
YKK6303-6	1600	990	188	95.5	0.86	0.7	6.5	1.8	10250
YKK7101-6	1800	990	213	95.8	0.85	0.5	7.0	1.8	14880
YKK7102-6	2000	990	236	95.9	0.85	0.5	7.0	1.8	15230
YKK7103-6	2240	990	264	96.0	0.85	0.5	7.0	1.8	15670
YKK7104-6	2500	990	295	96.1	0.85	0.5	7.0	1.8	15880
YKK4004-8	185	740	24.7	92.5	0.78	0.8	5.5	1.8	3830
YKK4005-8	200	740	26.6	92.7	0.78	0.8	5.5	1.8	3890
YKK4006-8	220	740	29.2	92.9	0.78	0.8	5.5	1.8	3940
YKK4502-8	250	740	32.7	93.0	0.79	0.8	5.5	1.8	4110
YKK4503-8	280	740	36.6	93.2	0.79	0.8	5.5	1.8	4200
YKK4504-8	315	740	41.1	93.4	0.79	0.8	5.5	1.8	4330
YKK4505-8	355	740	46.2	93.5	0.79	0.8	5.5	1.8	4460
YKK5001-8	400	740	51.3	93.7	0.80	0.8	5.5	1.8	5265
YKK5002-8	450	740	57.7	93.8	0.8	0.8	5.5	1.8	5425
YKK5003-8	500	740	63.8	94.2	0.8	0.8	5.5	1.8	5605
YKK5004-8	560	740	71.4	94.4	0.8	0.8	5.5	1.8	5775
YKK5601-8	630	740	78.2	94.5	0.82	0.7	6.0	1.8	6850
YKK5602-8	710	740	88.1	94.6	0.82	0.7	6.0	1.8	7050
YKK5603-8	800	740	99.1	94.7	0.82	0.7	6.0	1.8	7300
YKK6301-8	900	740	109	94.8	0.84	0.7	6.0	1.8	8270
YKK6302-8	1000	740	121	94.9	0.84	0.7	6.0	1.8	8675
YKK6303-8	1120	740	135	95.0	0.84	0.7	6.0	1.8	9080



Type	kW	r/min	A	%	cos $\phi$	$\frac{T_{st}}{T_n}$	$\frac{I_{st}}{I_n}$	$\frac{T_{max}}{T_n}$	kg
YKK6304-8	1250	740	150.6	95.1	0.84	0.7	6.0	1.8	9485
YKK7101-8	1400	740	168.5	95.2	0.84	0.6	7.0	1.8	14780
YKK7102-8	1600	740	192.3	95.3	0.84	0.6	7.0	1.8	15300
YKK7103-8	1800	740	216.1	95.4	0.84	0.6	7.0	1.8	15570
YKK4501-10	185	590	25.9	91.7	0.75	0.8	5.5	1.8	4080
YKK4502-10	200	590	27.9	91.9	0.75	0.8	5.5	1.8	4130
YKK4503-10	220	590	30.6	92.1	0.75	0.8	5.5	1.8	4210
YKK4504-10	250	590	34.8	92.3	0.75	0.8	5.5	1.8	4280
YKK4505-10	280	590	38.8	92.5	0.75	0.8	5.5	1.8	4520
YKK5001-10	315	590	43.0	92.8	0.76	0.8	5.5	1.8	5280
YKK5002-10	355	590	48.3	93.0	0.76	0.8	5.5	1.8	5375
YKK5003-10	400	590	54.3	93.3	0.76	0.8	5.5	1.8	5540
YKK5004-10	450	590	61.0	93.4	0.76	0.8	5.5	1.8	5700
YKK5601-10	500	590	65.9	93.6	0.78	0.7	6.0	1.8	5895
YKK5602-10	560	590	73.7	93.7	0.78	0.7	6.0	1.8	8100
YKK5603-10	630	590	82.9	93.8	0.78	0.7	6.0	1.8	8150
YKK5604-10	710	590	93.2	94.0	0.78	0.7	6.0	1.8	8300
YKK6301-10	800	590	102.2	94.2	0.80	0.7	6.0	1.8	9250
YKK6302-10	900	590	114.8	94.3	0.80	0.7	6.0	1.8	9550
YKK6303-10	1000	590	127.4	94.4	0.80	0.7	6.0	1.8	9850
YKK6304-10	1120	590	142.4	94.6	0.80	0.7	6.0	1.8	10400
YKK7101-10	1250	590	152.9	94.8	0.83	0.6	6.5	1.8	15350
YKK7102-10	1400	590	171	94.9	0.83	0.6	6.5	1.8	15780
YKK7103-10	1600	590	195	95.0	0.83	0.6	6.5	1.8	15890
YKK4504-12	185	495	27.7	91.8	0.70	0.8	5.5	1.8	4350
YKK4505-12	200	495	29.9	92.0	0.70	0.8	5.5	1.8	4370
YKK5001-12	220	495	31.9	92.2	0.72	0.8	5.5	1.8	5220
YKK5002-12	250	495	36.1	92.5	0.72	0.8	5.5	1.8	5395
YKK5003-12	280	495	40.4	92.7	0.72	0.8	5.5	1.8	5555
YKK5004-12	315	495	45.4	92.8	0.72	0.8	5.5	1.8	5815
YKK5601-12	355	495	49.6	93.0	0.74	0.7	6.0	1.8	6075
YKK5602-12	400	495	55.8	93.3	0.74	0.7	6.0	1.8	6200
YKK5603-12	450	495	62.7	93.4	0.74	0.7	6.0	1.8	7340
YKK5604-12	500	495	69.4	93.7	0.74	0.7	6.0	1.8	7620
YKK6301-12	560	495	75.6	93.8	0.76	0.7	6.0	1.8	7900
YKK6302-12	630	495	84.9	93.9	0.76	0.7	6.0	1.8	10700
YKK6303-12	710	495	95.6	94.0	0.76	0.7	6.0	1.8	10980
YKK6304-12	800	495	107.5	94.2	0.76	0.7	6.0	1.8	11260
YKK7101-12	900	495	116	94.4	0.79	0.6	6.5	1.8	15420
YKK7102-12	1000	495	129	94.4	0.79	0.6	6.5	1.8	15750
YKK7103-12	1120	495	144.4	94.5	0.79	0.6	6.5	1.8	15980
YKK7101-16	500	370	71.0	92.8	0.73	0.6	6.5	1.8	15350
YKK7102-16	560	370	79.5	92.9	0.73	0.6	6.5	1.8	15600
YKK7103-16	630	370	89.3	93.0	0.73	0.6	6.5	1.8	15800
YKK7104-16	710	370	100.4	93.2	0.73	0.6	6.5	1.8	16000

## YKK Series High Voltage Motor (10kv)

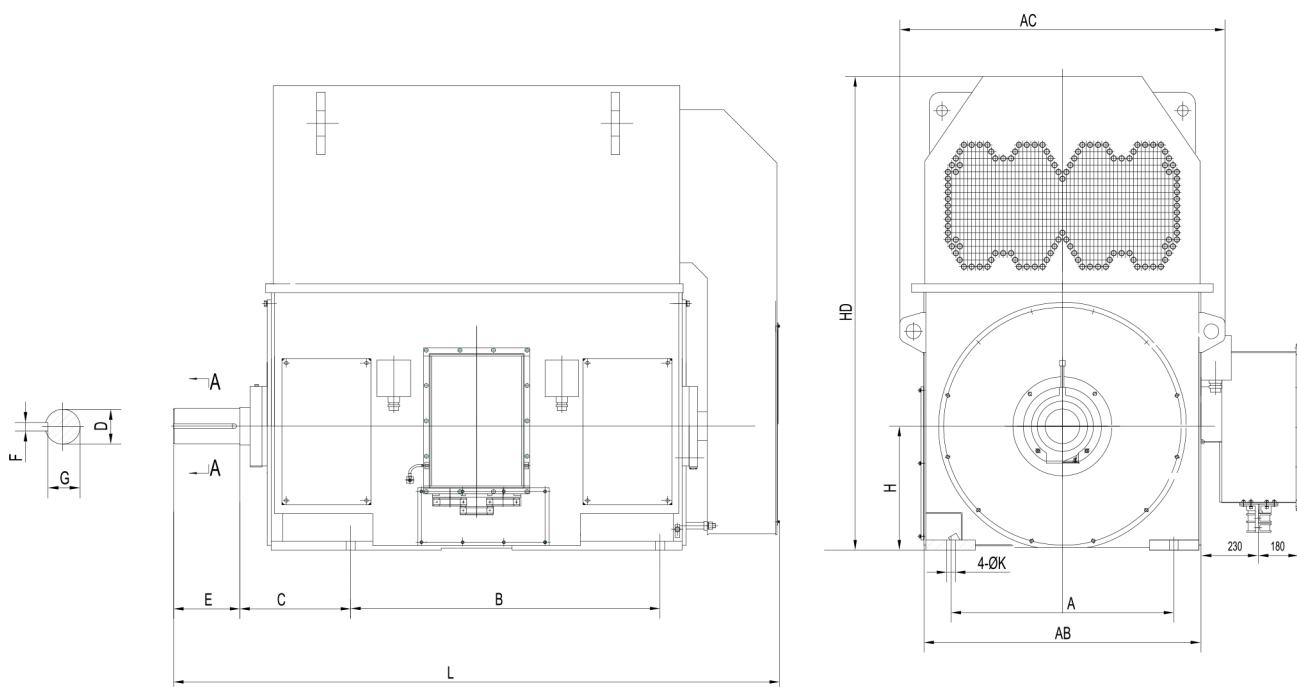

Frame	Pole	A	B	C	D	E	F	G	H	K	AB	AC	HD	L
450	2	800	1120	400	90	170	25	81	450	35	980	1174	1630	2390
450	4	800	1120	355	110	210	28	100	450	35	980	1174	1630	2390
450	6	800	1120	355	110	210	28	100	450	35	980	1174	1550	2390
500	2	900	1250	560	100	210	28	90	500	42	1120	1314	1980	2645
500	4	900	1250	475	120	210	32	109	500	42	1120	1314	1980	2560
500	6-10	900	1250	475	130	250	32	119	500	42	1120	1314	1780	2600
560	2	1000	1400	560	130	250	32	119	560	42	1220	1410	2100	2780
560	4	1000	1400	500	150	250	36	138	560	42	1220	1410	2100	2780
560	6-12	1000	1400	500	160	300	40	147	560	42	1220	1410	1900	2780
630	2	1120	1600	560	140	250	36	128	630	48	1360	1620	2250	3040
630	4	1120	1600	530	170	300	40	157	630	48	1360	1620	2250	2975
630	6-12	1120	1600	530	180	300	45	165	630	48	1360	1620	2250	2975
710	2	1400	1800	530	160	300	40	147	710	56	1600	1860	2250	3490
710	4-16	1400	1800	530	200	350	45	185	710	56	1600	1860	2300	3550



Type	kW	r/min	A	%	cos φ	$\frac{T_{st}}{T_n}$	$\frac{I_{st}}{I_n}$	$\frac{T_{max}}{T_n}$	kg
YKK4501-2	220	2980	15.7	92.7	0.87	0.6	7.0	1.8	3100
YKK4502-2	250	2980	17.9	92.8	0.87	0.6	7.0	1.8	3300
YKK4503-2	280	2980	20.0	92.9	0.87	0.6	7.0	1.8	3500
YKK4504-2	315	2980	22.4	93.2	0.87	0.6	7.0	1.8	3800
YKK4505-2	355	2980	25.2	93.5	0.87	0.6	7.0	1.8	3850
YKK4506-2	400	2980	28.3	93.8	0.87	0.6	7.0	1.8	3950
YKK4507-2	450	2980	31.8	94.0	0.87	0.6	7.0	1.8	4050
YKK4508-2	500	2980	35.3	94.1	0.87	0.6	7.0	1.8	4300
YKK5004-2	560	2980	39.4	94.3	0.87	0.6	7.0	1.8	5770
YKK5005-2	630	2980	44.3	94.4	0.87	0.6	7.0	1.8	5910
YKK5006-2	710	2980	49.3	94.5	0.88	0.6	7.0	1.8	6050
YKK5007-2	800	2980	55.5	94.6	0.88	0.6	7.0	1.8	6300
YKK5008-2	900	2980	62.4	94.7	0.88	0.6	7.0	1.8	6450
YKK5601-2	1000	2980	69.2	94.8	0.88	0.6	7.0	1.8	7000
YKK5602-2	1120	2980	77.4	95.0	0.88	0.6	7.0	1.8	7200
YKK5603-2	1250	2980	85.2	95.2	0.89	0.6	7.0	1.8	7400
YKK6301-2	1400	2980	95.3	95.3	0.89	0.6	7.0	1.8	9200
YKK6302-2	1600	2980	108.8	95.4	0.89	0.6	7.0	1.8	9500
YKK6303-2	1800	2980	122.3	95.5	0.89	0.6	7.0	1.8	10000
YKK7101-2	2000	2980	135.6	95.7	0.89	0.6	7.0	1.8	11850
YKK7102-2	2240	2980	151.7	95.8	0.89	0.6	7.0	1.8	12350
YKK7103-2	2500	2980	169.1	95.9	0.89	0.6	7.0	1.8	12600
YKK4501-4	220	1490	16.0	92.5	0.86	0.7	7.0	1.8	3540
YKK4502-4	250	1490	18.1	92.6	0.86	0.7	7.0	1.8	3770
YKK4503-4	280	1490	20.3	92.7	0.86	0.7	7.0	1.8	3870
YKK4504-4	315	1490	22.8	92.9	0.86	0.7	7.0	1.8	3900
YKK4505-4	355	1490	25.6	93.1	0.86	0.7	7.0	1.8	4210
YKK4506-4	400	1490	28.8	93.3	0.86	0.7	7.0	1.8	4310
YKK4507-4	450	1490	32.2	93.7	0.86	0.7	7.0	1.8	4500
YKK4508-4	500	1490	35.8	93.8	0.86	0.7	7.0	1.8	4920
YKK5004-4	560	1490	40.0	94.0	0.86	0.7	7.0	1.8	5670
YKK5005-4	630	1490	44.9	94.2	0.86	0.7	7.0	1.8	5860
YKK5006-4	710	1490	49.7	94.8	0.87	0.7	7.0	1.8	6040
YKK5007-4	800	1490	55.9	94.9	0.87	0.7	7.0	1.8	6070
YKK5008-4	900	1490	62.2	95.0	0.88	0.7	7.0	1.8	6630
YKK5601-4	1000	1490	69.6	95.1	0.88	0.7	7.0	1.8	6900
YKK5602-4	1120	1490	77.2	95.2	0.88	0.7	7.0	1.8	7100
YKK5603-4	1250	1490	85.1	95.3	0.89	0.7	7.0	1.8	7300
YKK6301-4	1400	1490	95.1	95.5	0.89	0.6	7.0	1.8	10500

Type	kW	r/min	A	%	cos $\phi$	$\frac{T_{st}}{T_n}$	$\frac{I_{st}}{I_n}$	$\frac{T_{max}}{T_n}$	kg
YKK6302-4	1600	1490	108.6	95.6	0.89	0.6	7.0	1.8	11000
YKK6303-4	1800	1490	122	95.7	0.89	0.6	7.0	1.8	12200
YKK7101-4	2000	1490	140.6	95.5	0.86	0.5	6.5	1.8	12850
YKK7102-4	2240	1490	157.3	95.6	0.86	0.5	6.5	1.8	13100
YKK7103-4	2500	1490	175.4	95.7	0.86	0.5	6.5	1.8	13640
YKK4504-6	220	990	16.8	92.1	0.82	0.7	6.0	1.8	4100
YKK4505-6	250	990	19.1	92.2	0.82	0.7	6.0	1.8	4220
YKK4506-6	280	990	21.3	92.4	0.82	0.7	6.0	1.8	4430
YKK4507-6	315	990	24.0	92.6	0.82	0.7	6.0	1.8	4570
YKK4508-6	355	990	26.6	92.9	0.83	0.7	6.0	1.8	4600
YKK5004-6	400	990	29.9	93.1	0.83	0.7	6.0	1.8	5450
YKK5005-6	450	990	33.6	93.3	0.83	0.7	6.0	1.8	5710
YKK5006-6	500	990	37.1	93.7	0.83	0.7	6.0	1.8	5890
YKK5007-6	560	990	41.0	93.9	0.84	0.7	6.0	1.8	6120
YKK5008-6	630	990	46.0	94.2	0.84	0.7	6.0	1.8	6680
YKK5601-6	710	990	51.7	94.4	0.84	0.7	6.5	1.8	6950
YKK5602-6	800	990	58.2	94.5	0.84	0.7	6.5	1.8	7300
YKK5603-6	900	990	64.6	94.7	0.85	0.7	6.5	1.8	7400
YKK5604-6	1000	990	71.6	94.9	0.85	0.7	6.5	1.8	7700
YKK6301-6	1120	990	80.0	95.1	0.85	0.6	6.5	1.8	9400
YKK6302-6	1250	990	88.2	95.2	0.86	0.6	6.5	1.8	10400
YKK6303-6	1400	990	98.4	95.5	0.86	0.6	6.5	1.8	16500
YKK7101-6	1600	990	119.2	94.5	0.82	0.6	6.5	1.8	13900
YKK7102-6	1800	990	134	94.6	0.82	0.6	6.5	1.8	14250
YKK7103-6	2000	990	148.7	94.7	0.82	0.6	6.5	1.8	15010
YKK5002-8	220	740	18.1	92.1	0.76	0.7	6.0	1.8	5250
YKK5003-8	250	740	20.6	92.2	0.76	0.7	6.0	1.8	5440
YKK5004-8	280	740	23.0	92.4	0.76	0.7	6.0	1.8	5670
YKK5005-8	315	740	25.5	92.6	0.77	0.7	6.0	1.8	5710
YKK5006-8	355	740	28.7	92.9	0.77	0.7	6.0	1.8	5770
YKK5007-8	400	740	31.8	93.0	0.78	0.7	6.0	1.8	5830
YKK5008-8	450	740	35.7	93.2	0.78	0.7	6.0	1.8	6370
YKK5601-8	500	740	39	93.6	0.79	0.7	6.0	1.8	7200
YKK5602-8	560	740	43.7	93.7	0.79	0.7	6.0	1.8	7300
YKK5603-8	630	740	47.1	94.2	0.82	0.7	6.0	1.8	7400
YKK5604-8	710	740	53.0	94.4	0.82	0.7	6.0	1.8	7500
YKK6301-8	800	740	59.6	94.5	0.82	0.7	6.0	1.8	9300
YKK6302-8	900	740	67.0	94.6	0.82	0.7	6.0	1.8	9800
YKK6303-8	1000	740	73.4	94.8	0.83	0.7	6.0	1.8	10000



Type	kW	r/min	A	%	cos $\phi$	$\frac{T_{st}}{T_n}$	$\frac{I_{st}}{I_n}$	$\frac{T_{max}}{T_n}$	kg
YKK7101-8	1120	740	86.1	93.9	0.80	0.6	6.5	1.8	14370
YKK7102-8	1250	740	96.0	94.0	0.80	0.6	6.5	1.8	15250
YKK7103-8	1400	740	107.4	94.1	0.80	0.6	6.5	1.8	15560
YKK7104-8	1600	740	122.6	94.2	0.8	0.6	6.5	1.8	15700
YKK5005-10	220	590	19.0	91.8	0.73	0.7	5.5	1.8	5770
YKK5006-10	250	590	21.5	92.0	0.73	0.7	5.5	1.8	5940
YKK5007-10	280	590	23.7	92.2	0.74	0.7	5.5	1.8	6130
YKK5008-10	315	590	26.6	92.4	0.74	0.7	5.5	1.8	6200
YKK5601-10	355	590	29.5	92.6	0.75	0.7	6.0	1.8	6700
YKK5602-10	400	590	33.2	92.8	0.75	0.7	6.0	1.8	6900
YKK5603-10	450	590	36.3	93.0	0.77	0.7	6.0	1.8	7100
YKK5604-10	500	590	40.2	93.2	0.77	0.7	6.0	1.8	7300
YKK5605-10	560	590	44.4	93.3	0.78	0.7	6.0	1.8	7500
YKK6301-10	630	590	49.9	93.5	0.78	0.7	6.0	1.8	9400
YKK6302-10	710	590	54.7	93.7	0.80	0.7	6.0	1.8	9650
YKK6303-10	800	590	61.4	94.1	0.80	0.7	6.0	1.8	9850
YKK6304-10	900	590	68.9	94.3	0.80	0.7	6.0	1.8	10500
YKK7101-10	1000	590	79.1	93.6	0.78	0.6	6.0	1.8	14780
YKK7102-10	1120	590	88.5	93.7	0.78	0.6	6.0	1.8	15320
YKK7103-10	1250	590	98.6	93.8	0.78	0.6	6.0	1.8	15650
YKK5601-12	220	495	19.8	91.6	0.70	0.7	6.0	1.8	6600
YKK5602-12	250	495	22.5	91.7	0.70	0.7	6.0	1.8	6700
YKK5603-12	280	495	24.4	91.9	0.72	0.7	6.0	1.8	6900
YKK5604-12	315	495	27.4	92.1	0.72	0.7	6.0	1.8	7100
YKK5605-12	355	495	30.8	92.3	0.72	0.7	6.0	1.8	7300
YKK5606-12	400	495	34.7	92.5	0.72	0.7	6.0	1.8	7500
YKK6301-12	450	495	38.4	92.7	0.73	0.7	6.0	1.8	9400
YKK6302-12	500	495	42.5	93.0	0.73	0.7	6.0	1.8	9650
YKK6303-12	560	495	47.5	93.3	0.73	0.7	6.0	1.8	9850
YKK6304-12	630	495	53.3	93.5	0.73	0.7	6.0	1.8	10500
YKK7101-12	710	495	60.4	93.0	0.73	0.6	6.0	1.8	14740
YKK7102-12	800	495	68.0	93.1	0.73	0.6	6.0	1.8	15150
YKK7103-12	900	495	76.4	93.2	0.73	0.6	6.0	1.8	15580
YKK7101-16	355	370	30.4	92.5	0.73	0.6	6.0	1.8	14930
YKK7102-16	400	370	34.2	92.6	0.73	0.6	6.0	1.8	14250
YKK7103-16	450	370	38.4	92.7	0.73	0.6	6.0	1.8	14840
YKK7104-16	500	370	42.6	92.8	0.73	0.6	6.0	1.8	15100