

YLKK 系列（6kV IP44、IP54、IP55）立式高压三相异步电动机技术数据 Technical Data（6kV IP44、IP54、IP55）

型号 Type	额定功率 Rated Output (kW)	额定转速 Rated Speed (r/min)	额定电流 Rated Current (A)	效率 (%) Efficiency	功率因数 Power Factor (cosφ)	堵转电流 额定电流 Locked current Rated current	堵转转矩 额定转矩 Locked torque Rated torque	最大转矩 额定转矩 Max. Torque Rated torque	重量 Weight (kg)
YLKK3551-4	185	1480	22.8	91.9	0.85	6.5	0.7	1.8	2650
YLKK3552-4	200	1480	24.6	92.1	0.85	6.5	0.7	1.8	2700
YLKK3553-4	220	1480	27.0	92.2	0.85	6.5	0.7	1.8	2730
YLKK3554-4	250	1480	30.7	92.3	0.85	6.5	0.7	1.8	2770
YLKK3555-4	280	1480	33.9	92.4	0.86	6.5	0.7	1.8	2850
YLKK3556-4	315	1480	38.1	92.6	0.86	6.5	0.7	1.8	2930
YLKK4001-4	355	1480	42.8	92.8	0.86	6.5	0.7	1.8	3430
YLKK4002-4	400	1480	48.1	93.0	0.86	6.5	0.7	1.8	3530
YLKK4003-4	450	1480	54.0	93.2	0.86	6.5	0.7	1.8	3610
YLKK4004-4	500	1480	59.9	93.4	0.86	6.5	0.7	1.8	3740
YLKK4005-4	560	1480	66.9	93.6	0.86	6.5	0.7	1.8	4350
YLKK4502-4	630	1480	75.2	93.8	0.86	6.5	0.7	1.8	4620
YLKK4503-4	710	1480	84.5	94.0	0.86	6.5	0.7	1.8	4720
YLKK4504-4	800	1480	93.8	94.3	0.87	6.5	0.7	1.8	4860
YLKK4505-4	900	1480	105.5	94.4	0.87	6.5	0.7	1.8	4990
YLKK5002-4	1000	1480	117.0	94.5	0.87	6.5	0.7	1.8	5780
YLKK5003-4	1120	1480	131.0	94.6	0.87	6.5	0.7	1.8	5950
YLKK5004-4	1250	1480	144.2	94.8	0.88	6.5	0.7	1.8	6140
YLKK5005-4	1400	1480	161.3	94.9	0.88	6.5	0.7	1.8	6330
YLKK5601-4	1600	1480	184.2	95.0	0.88	6.5	0.6	1.8	7530
YLKK5602-4	1800	1480	207.0	95.1	0.88	6.5	0.6	1.8	7700
YLKK5603-4	2000	1480	229.5	95.3	0.88	6.5	0.6	1.8	7910

SUNVIM

YLKK6301-4	2100	1480	241.0	95.3	0.88	6.5	0.6	1.8	9750
YLKK6302-4	2240	1480	256.8	95.4	0.88	6.5	0.6	1.8	9900
YLKK6303-4	2350	1480	269.4	95.4	0.88	6.5	0.6	1.8	1050
YLKK6304-4	2500	1480	286.3	95.5	0.88	6.5	0.6	1.8	10200
YLKK6305-4	2650	1480	303.1	95.6	0.88	6.5	0.6	1.8	10330
YLKK6306-4	2800	1480	320.3	95.6	0.88	6.5	0.6	1.8	10600
YLKK6307-4	2900	1480	331.7	95.6	0.88	6.5	0.6	1.8	10750
YLKK6308-4	3150	1480	359.6	95.8	0.88	6.5	0.6	1.8	10950
YLKK3553-6	185	980	23.7	91.5	0.82	6.0	0.7	1.8	2730
YLKK3554-6	200	980	25.6	91.8	0.82	6.0	0.7	1.8	2770
YLKK3555-6	220	980	28.1	92.0	0.82	6.0	0.7	1.8	2850
YLKK3556-6	250	980	31.8	92.2	0.82	6.0	0.7	1.8	2930
YLKK4002-6	280	980	35.5	92.5	0.82	6.0	0.7	1.8	3330
YLKK4003-6	315	980	39.8	92.8	0.82	6.0	0.7	1.8	3380
YLKK4004-6	355	980	44.3	93.0	0.83	6.0	0.7	1.8	3470
YLKK4005-6	400	980	49.8	93.1	0.83	6.0	0.7	1.8	3560
YLKK4502-6	450	980	55.9	93.4	0.83	6.0	0.7	1.8	4100
YLKK4503-6	500	980	61.9	93.7	0.83	6.0	0.7	1.8	4250
YLKK4504-6	560	980	68.4	93.8	0.84	6.0	0.7	1.8	4410
YLKK4505-6	630	980	76.9	93.9	0.84	6.0	0.7	1.8	4600
YLKK5002-6	710	980	86.3	94.2	0.84	6.0	0.7	1.8	5550
YLKK5003-6	800	980	97.1	94.4	0.84	6.0	0.7	1.8	5750
YLKK5004-6	900	980	107.8	94.5	0.85	6.0	0.7	1.8	5920
YLKK5005-6	1000	980	119.7	94.6	0.85	6.0	0.7	1.8	6080
YLKK5601-6	1120	980	133.9	94.7	0.85	6.5	0.7	1.8	7400
YLKK5602-6	1250	980	147.4	94.9	0.86	6.5	0.7	1.8	7610
YLKK5603-6	1400	980	164.9	95.0	0.86	6.5	0.7	1.8	7830
YLKK6304-6	1600	980	188.3	95.1	0.86	6.5	0.7	1.8	9800
YLKK6305-6	1800	980	211.6	95.2	0.86	6.5	0.7	1.8	10150

SUNVIM

YLKK6306-6	2000	980	234.6	95.4	0.86	6.5	0.7	1.8	10350
YLKK6307-6	2100	980	246.3	95.4	0.86	6.5	0.7	1.8	10500
YLKK6308-6	2240	980	262.5	95.5	0.86	6.5	0.7	1.8	10710
YLKK4001-8	185	740	24.9	91.6	0.78	5.5	0.8	1.8	3280
YLKK4002-8	200	740	26.8	91.9	0.78	5.5	0.8	1.8	3350
YLKK4003-8	220	740	29.5	92.1	0.78	5.5	0.8	1.8	3390
YLKK4004-8	250	740	33.0	92.2	0.79	5.5	0.8	1.8	3480
YLKK4005-8	280	740	36.9	92.4	0.79	5.5	0.8	1.8	3600
YLKK4502-8	315	740	41.4	92.7	0.79	5.5	0.8	1.8	4270
YLKK4503-8	355	740	46.6	92.8	0.79	5.5	0.8	1.8	4400
YLKK4504-8	400	740	51.7	93.0	0.80	5.5	0.8	1.8	4530
YLKK4505-8	450	740	58.1	93.1	0.80	5.5	0.8	1.8	4630
YLKK5002-8	500	740	64.3	93.6	0.80	5.5	0.8	1.8	5800
YLKK5003-8	560	740	71.8	93.8	0.8	5.5	0.8	1.8	5950
YLKK5004-8	630	740	78.7	93.9	0.82	5.5	0.8	1.8	6100
YLKK5005-8	710	740	88.6	94.0	0.82	5.5	0.8	1.8	6250
YLKK5601-8	800	740	99.7	94.2	0.82	6.0	0.7	1.8	7150
YLKK5602-8	900	740	109.3	94.3	0.84	6.0	0.7	1.8	7400
YLKK5603-8	1000	740	121.4	94.4	0.84	6.0	0.7	1.8	7670
YLKK6304-8	1120	740	135.8	94.5	0.84	6.0	0.7	1.8	10100
YLKK6305-8	1250	740	151.2	94.7	0.84	6.0	0.7	1.8	10350
YLKK6306-8	1400	740	169.2	94.8	0.84	6.0	0.7	1.8	10530
YLKK6307-8	1600	740	193.1	94.9	0.84	6.0	0.7	1.8	10700
YLKK6308-8	1800	740	217.1	95.0	0.84	6.0	0.7	1.8	10850
YLKK4004-10	185	590	26.1	90.8	0.75	5.5	0.8	1.8	3480
YLKK4005-10	200	590	28.2	91.1	0.75	5.5	0.8	1.8	3580
YLKK4501-10	220	590	30.9	91.3	0.75	5.5	0.8	1.8	4050
YLKK4502-10	250	590	35.1	91.5	0.75	5.5	0.8	1.8	4100

SUNVIM

YLKK4503-10	280	590	39.2	91.7	0.75	5.5	0.8	1.8	4150
YLKK4504-10	315	590	43.3	92.1	0.76	5.5	0.8	1.8	4230
YLKK4505-10	355	590	48.7	92.3	0.76	5.5	0.8	1.8	4550
YLKK5001-10	400	590	54.7	92.6	0.76	5.5	0.8	1.8	5780
YLKK5002-10	450	590	61.5	92.7	0.76	5.5	0.8	1.8	5920
YLKK5003-10	500	590	66.3	93.0	0.78	5.5	0.8	1.8	6060
YLKK5004-10	560	590	74.2	93.1	0.78	5.5	0.8	1.8	6140
YLKK5005-10	630	590	83.4	93.2	0.78	5.5	0.8	1.8	6260
YLKK5601-10	710	590	93.8	93.4	0.78	6.0	0.7	1.8	7210
YLKK5602-10	800	590	102.7	93.7	0.80	6.0	0.7	1.8	7400
YLKK5603-10	900	590	115.4	93.8	0.80	6.0	0.7	1.8	7660
YLKK6304-10	1000	590	128.1	93.9	0.80	6.0	0.7	1.8	10170
YLKK6305-10	1120	590	143.2	94.1	0.80	6.0	0.7	1.8	10350
YLKK6306-10	1250	590	159.3	94.4	0.80	6.0	0.7	1.8	10530
YLKK6307-10	1400	590	178.2	94.5	0.80	6.0	0.7	1.8	10690
YLKK6308-10	1600	590	203.4	94.6	0.80	6.0	0.7	1.8	10800
YLKK4502-12	185	490	28.0	90.9	0.70	5.5	0.8	1.8	4100
YLKK4503-12	200	490	30.1	91.2	0.70	5.5	0.8	1.8	4150
YLKK4504-12	220	490	32.2	91.4	0.72	5.5	0.8	1.8	4230
YLKK4505-12	250	490	36.4	91.7	0.72	5.5	0.8	1.8	4550
YLKK5001-12	280	490	40.7	91.9	0.72	5.5	0.8	1.8	5830
YLKK5002-12	315	490	45.8	92.0	0.72	5.5	0.8	1.8	5930
YLKK5003-12	355	490	50.0	92.3	0.74	5.5	0.8	1.8	6060
YLKK5004-12	400	490	56.2	92.6	0.74	5.5	0.8	1.8	6280
YLKK5005-12	450	490	63.1	92.7	0.74	5.5	0.8	1.8	6360
YLKK5601-12	500	490	69.8	93.1	0.74	6.0	0.7	1.8	7550
YLKK5602-12	560	490	76.1	93.2	0.76	6.0	0.7	1.8	7710
YLKK5603-12	630	490	85.5	93.3	0.76	6.0	0.7	1.8	7870
YLKK6304-12	710	490	96.2	93.4	0.76	6.0	0.7	1.8	9990

SUNVIM

YLKK6305-12	800	490	108.1	93.7	0.76	6.0	0.7	1.8	10270
YLKK6306-12	900	490	121.5	93.8	0.76	6.0	0.7	1.8	10510
YLKK6307-12	1000	490	134.8	93.9	0.76	6.0	0.7	1.8	10710
YLKK6308-12	1120	490	150.9	94.0	0.76	6.0	0.7	1.8	10900

YLKK 系列（10kV IP44, IP54, IP55）立式高压三相异步电动机技术数据 Technical Data（10kV IP44, IP54, IP55）

型号 Type	额定功率 Rated Output (kW)	额定转速 Rated Speed (r/min)	额定电流 Rated Current (A)	效率 (%) Efficiency	功率因数 Power Factor ($\cos \phi$)	<u>堵转电流</u> 额定电流 Locked current Rated current	<u>堵转转矩</u> 额定转矩 Locked torque Rated torque	<u>最大转矩</u> 额定转矩 Max. torque Rated torque	重量 Weight (kg)
YLKK4001-4	220	1485	16.7	91.4	0.83	7.0	0.7	1.8	3080
YLKK4002-4	250	1485	19.0	91.6	0.83	7.0	0.7	1.8	3150
YLKK4003-4	280	1485	21.2	91.8	0.83	7.0	0.7	1.8	3230
YLKK4004-4	315	1485	23.8	92.1	0.83	7.0	0.7	1.8	3350
YLKK4005-4	355	1485	25.8	92.3	0.86	7.0	0.7	1.8	3480
YLKK4006-4	400	1485	29.0	92.5	0.86	7.0	0.7	1.8	3530
YLKK4501-4	450	1485	32.5	92.9	0.86	7.0	0.7	1.8	4350
YLKK4502-4	500	1485	36.1	93.0	0.86	7.0	0.7	1.8	4420
YLKK4503-4	560	1485	40.3	93.3	0.86	7.0	0.7	1.8	4570
YLKK4504-4	630	1485	45.2	93.5	0.86	7.0	0.7	1.8	4620
YLKK4505-4	710	1485	50.7	94.1	0.86	7.0	0.7	1.8	4870
YLKK5003-4	800	1485	56.3	94.3	0.87	7.0	0.7	1.8	5970
YLKK5004-4	900	1485	63.3	94.4	0.87	7.0	0.7	1.8	6070
YLKK5005-4	1000	1485	70.2	94.5	0.87	7.0	0.7	1.8	6260
YLKK5006-4	1120	1485	78.6	94.6	0.87	7.0	0.7	1.8	6420
YLKK5602-4	1250	1485	86.6	94.7	0.88	7.0	0.7	1.8	7240

SUNVIM

YLKK5603-4	1400	1485	96.7	95.0	0.88	7.0	0.7	1.8	7490
YLKK5604-4	1600	1485	110.4	95.1	0.88	7.0	0.7	1.8	7670
YLKK5605-4	1800	1485	124.1	95.2	0.88	7.0	0.7	1.8	7870
YLKK6301-4	2000	1485	137.5	95.4	0.88	7.0	0.6	1.8	10270
YLKK6302-4	2100	1485	144.4	95.4	0.88	7.0	0.6	1.8	10480
YLKK6303-4	2240	1485	153.9	95.5	0.88	7.0	0.6	1.8	10670
YLKK6304-4	2350	1485	161.4	95.5	0.88	7.0	0.6	1.8	10830
YLKK6305-4	2500	1485	171.8	95.5	0.88	7.0	0.6	1.8	10980
YLKK4004-6	220	980	17.4	91.2	0.80	6.0	0.7	1.8	3330
YLKK4005-6	250	980	19.7	91.4	0.80	6.0	0.7	1.8	3460
YLKK4006-6	280	980	22.0	91.7	0.80	6.0	0.7	1.8	3510
YLKK4501-6	315	980	24.1	92.0	0.82	6.0	0.7	1.8	4250
YLKK4502-6	355	980	26.8	92.2	0.83	6.0	0.7	1.8	4370
YLKK4503-6	400	980	30.1	92.4	0.83	6.0	0.7	1.8	4470
YLKK4504-6	450	980	33.8	92.6	0.83	6.0	0.7	1.8	4630
YLKK4505-6	500	980	37.4	93.0	0.83	6.0	0.7	1.8	4810
YLKK5002-6	560	980	41.3	93.3	0.84	6.0	0.7	1.8	5780
YLKK5003-6	630	980	46.3	93.6	0.84	6.0	0.7	1.8	5960
YLKK5004-6	710	980	52.0	93.8	0.84	6.0	0.7	1.8	6180
YLKK5005-6	800	980	58.5	94.0	0.84	6.0	0.7	1.8	6320
YLKK5006-6	900	980	64.9	94.2	0.85	6.0	0.7	1.8	6440
YLKK5602-6	1000	980	72.0	94.4	0.85	6.0	0.7	1.8	7350
YLKK5603-6	1120	980	80.4	94.6	0.85	6.0	0.7	1.8	7500
YLKK5604-6	1250	980	88.6	94.7	0.86	6.0	0.7	1.8	7730
YLKK5605-6	1400	980	98.8	95.1	0.86	6.0	0.7	1.8	7880
YLKK6301-6	1600	980	112.8	95.2	0.86	6.0	0.6	1.8	10300
YLKK6302-6	1800	980	126.8	95.3	0.86	6.0	0.6	1.8	10600
YLKK6303-6	2000	980	140.7	95.4	0.86	6.0	0.6	1.8	10850

SUNVIM

YLKK6304-6	2100	980	147.8	95.4	0.86	6.0	0.6	1.8	10980
YLKK6305-6	2240	980	157.6	95.4	0.86	6.0	0.6	1.8	11130
YLKK4502-8	220	740	18.6	91.1	0.75	6.0	0.7	1.8	4250
YLKK4503-8	250	740	21.1	91.3	0.75	6.0	0.7	1.8	4370
YLKK4504-8	280	740	23.2	91.6	0.76	6.0	0.7	1.8	4470
YLKK4505-8	315	740	25.7	92.0	0.77	6.0	0.7	1.8	4630
YLKK5001-8	355	740	28.8	92.4	0.77	6.0	0.7	1.8	5600
YLKK5002-8	400	740	32.0	92.5	0.78	6.0	0.7	1.8	5780
YLKK5003-8	450	740	35.9	92.7	0.78	6.0	0.7	1.8	5850
YLKK5004-8	500	740	39.3	93.1	0.79	6.0	0.7	1.8	5950
YLKK5005-8	560	740	43.9	93.3	0.79	6.0	0.7	1.8	6060
YLKK5006-8	630	740	47.3	93.8	0.82	6.0	0.7	1.8	6180
YLKK5602-8	710	740	53.2	94.0	0.82	6.0	0.7	1.8	7180
YLKK5603-8	800	740	59.8	94.2	0.82	6.0	0.7	1.8	7300
YLKK5604-8	900	740	67.2	94.3	0.82	6.0	0.7	1.8	7480
YLKK5605-8	1000	740	75.4	94.5	0.81	6.0	0.7	1.8	7730
YLKK6302-8	1120	740	82.3	94.7	0.83	6.0	0.7	1.8	10100
YLKK6303-8	1250	740	91.7	94.8	0.83	6.0	0.7	1.8	10300
YLKK6304-8	1400	740	102.6	94.9	0.83	6.0	0.7	1.8	10610
YLKK6305-8	1600	740	117.3	94.9	0.83	6.0	0.7	1.8	10900
YLKK4505-10	220	590	19.4	91.0	0.72	5.5	0.7	1.8	4610
YLKK5001-10	250	590	22.0	91.2	0.72	5.5	0.7	1.8	5600
YLKK5002-10	280	590	23.9	91.5	0.74	5.5	0.7	1.8	5750
YLKK5003-10	315	590	26.8	91.7	0.74	5.5	0.7	1.8	5820
YLKK5004-10	355	590	29.7	92.1	0.75	5.5	0.7	1.8	5930
YLKK5005-10	400	590	33.4	92.3	0.75	5.5	0.7	1.8	6020
YLKK5006-10	450	590	37.0	92.5	0.76	5.5	0.7	1.8	6150
YLKK5601-10	500	590	40.4	92.7	0.77	6.0	0.7	1.8	7000

SUNVIM

YLKK5602-10	560	590	44.6	92.9	0.78	6.0	0.7	1.8	7230
YLKK5603-10	630	590	50.1	93.1	0.78	6.0	0.7	1.8	7400
YLKK5604-10	710	590	56.3	93.3	0.78	6.0	0.7	1.8	7610
YLKK5605-10	800	590	63.1	93.8	0.78	6.0	0.7	1.8	7770
YLKK6301-10	900	590	69.1	94.0	0.80	6.0	0.7	1.8	10310
YLKK6302-10	1000	590	76.7	94.1	0.80	6.0	0.7	1.8	10500
YLKK6303-10	1120	590	85.8	94.2	0.80	6.0	0.7	1.8	10730
YLKK6304-10	1250	590	95.8	94.2	0.80	6.0	0.7	1.8	10840
YLKK6305-10	1400	590	107.1	94.3	0.80	6.0	0.7	1.8	11000
YLKK5003-12	220	490	19.4	90.9	0.72	5.5	0.7	1.8	5800
YLKK5004-12	250	490	22.0	91.1	0.72	5.5	0.7	1.8	5920
YLKK5005-12	280	490	24.6	91.3	0.72	5.5	0.7	1.8	6020
YLKK5006-12	315	490	27.6	91.5	0.72	5.5	0.7	1.8	6160
YLKK5601-12	355	490	31.0	91.8	0.72	6.0	0.7	1.8	7000
YLKK5602-12	400	490	34.4	92.0	0.73	6.0	0.7	1.8	7150
YLKK5603-12	450	490	38.6	92.2	0.73	6.0	0.7	1.8	7410
YLKK5604-12	500	490	42.8	92.5	0.73	6.0	0.7	1.8	7620
YLKK5605-12	560	490	47.0	92.9	0.74	6.0	0.7	1.8	7830
YLKK6301-12	630	490	52.8	93.1	0.74	6.0	0.7	1.8	10250
YLKK6302-12	710	490	59.4	93.3	0.74	6.0	0.7	1.8	10470
YLKK6303-12	800	490	66.5	93.8	0.74	6.0	0.7	1.8	10700
YLKK6304-12	900	490	74.9	93.8	0.74	6.0	0.7	1.8	10830
YLKK6305-12	1000	490	83.2	93.8	0.74	6.0	0.7	1.8	11000

SUNVIM

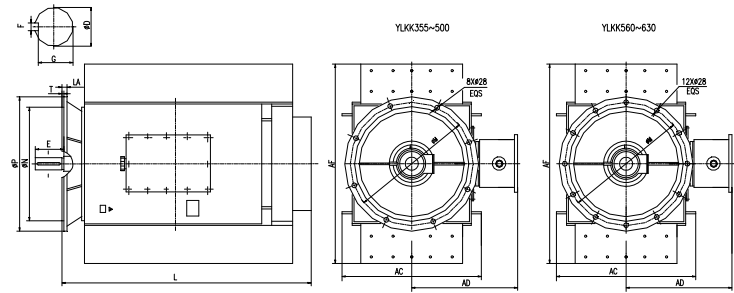

YLKK 系列（6kV IP44,IP54,IP55）立式高压三相异步电动机安装尺寸表 Mounting and overall dimensions

机座号 Frame No.	极数 No of pole	N	P	M	D	E	F	G	T	LA	AC	AD	L	AF
355	4,6	880	1000	940	100	210	28	90	6	32	1100	800	2300	1500
400	4,6,8,10	1000	1150	1080	110	210	28	100	6	35	1150	850	2500	1650
450	4	1120	1250	1180	120	210	32	109	6	35	1300	900	2700	1800
	6,8,10,12				130	250		119						
500	4	1250	1400	1320	130	250	32	119	8	35	1400	965	2900	2000
	6,8,10,12				140		36	128						
560	4	1400	1600	1500	150	250	36	138	8	42	1600	1100	3300	2200
	6,8,10,12				160	300	40	147						
630	4	1600	1800	1700	170	300	40	157	9	42	1800	1200	3600	2400
	6,8,10,12				180		45	165						

SUNVIM

YLKK 系列（10kV IP44,IP54,IP55）立式高压三相异步电动机安装尺寸表 Mounting and overall dimensions

机座号 Frame No.	极数 No of pole	N	P	M	D	E	F	G	T	LA	AC	AD	L
400	4,6	1000	1150	1080	110	210	28	100	6	35	1100	800	2500
450	4,6,8,10	1120	1250	1180	110	210	28	100	6	35	1300	1050	2700
500	4	1250	1400	1320	130	210	32	119	8	35	1400	1110	2900
	6,8,10,12					250							
560	4	1400	1600	1500	150	250	36	138	8	42	1600	1200	3300
	6,8,10,12				160	300	40	147					
630	4	1600	1800	1700	170	300	40	157	9	42	1800	1300	3600
	6,8,10,12				180		45	165					